

NEW LOGIS- TICS CENTRE

A new logistics centre will be opened at the University of Oulu campus **in April 2019**. It will be the main hub of all daily deliveries to and from the university.

Temporary detours at the building site:

- No trespassing through Virransilta in the east-west direction
- The courtyard on the west side of Virransilta is part of the building site
- West side entrance is through door F2
- Bicycle parking is in front of door F2
- Only emergency exit is allowed through entrance F1
- Detours will be in effect **1.12.2018 – 31.3.2019**

NEW LOGISTICS CENTRE

completion in April of 2019

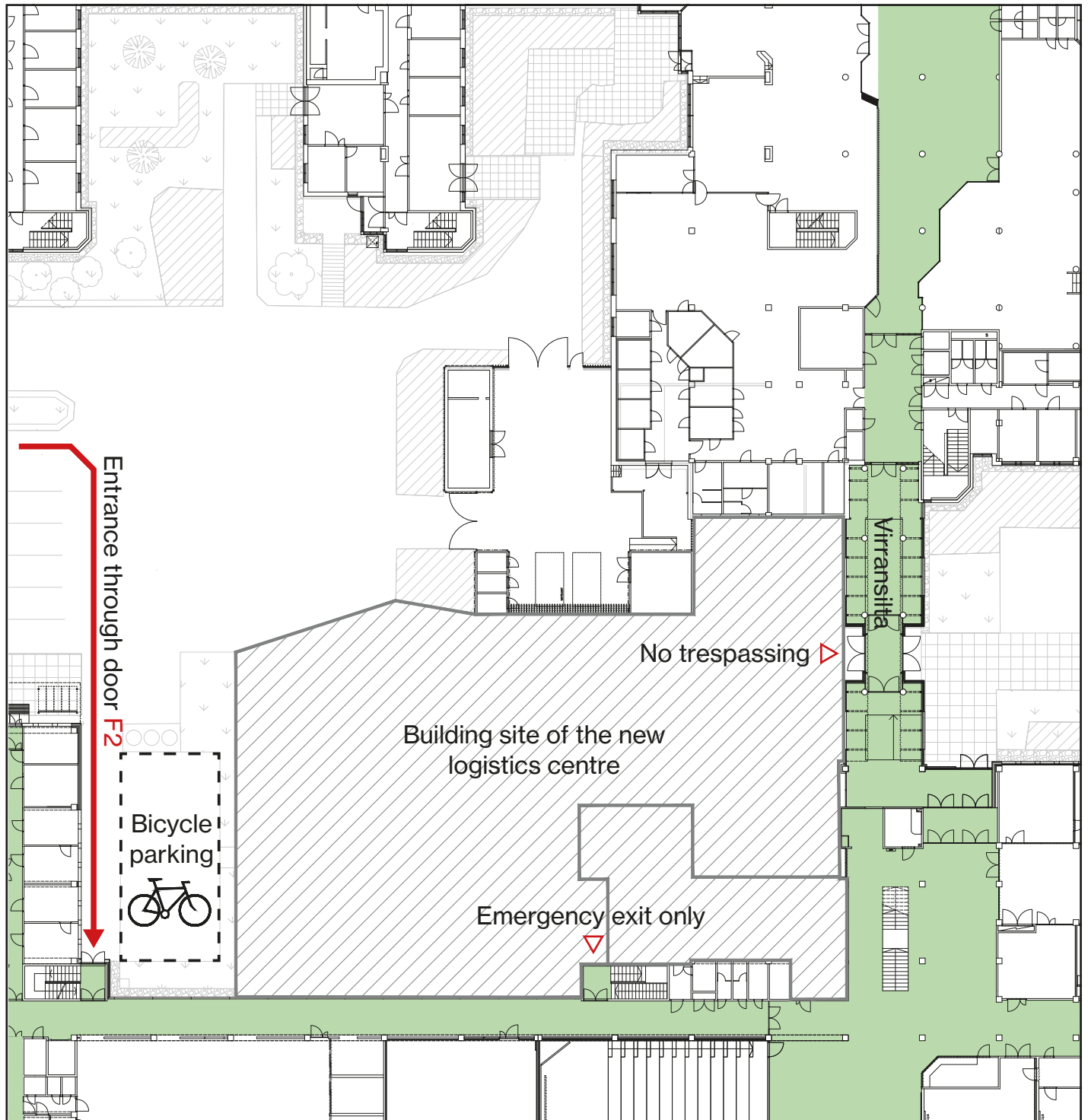

MORE INFORMATION:

Main contractor	Rakennuspalvelu Kurtti Oy	Pentti Mäkinen	pentti.makinen @pp2.inet.fi
University of Oulu	Facilities services	Facilities engineer Timo Haverinen	timo.haverinen@oulu.fi
Construction consultant	A-Insinöörit	Arttu Niemikorpi	arttu.niemikorpi@ains.fi
Principal design	Linja Arkkitehdit Oy	Architect Henri Kangas	henri.kangas @linja-arkkitehdit.fi